

37.04 M / 121'53"



MAIN CHARACTERISTICS

Builder	Ferretti Custom Line
Designer	Francesco Pawkowski
Built Year	2019
Hull Material	GRP
Length	37.04 M / 121'53"
Beam	8.00 M / 26'25"
Draft	2.26 M / 7'41"
Displacement	209.00 tons
Registry	Portugal
Tax Status	VAT unpaid

13,800,000 EUR 14,363,771 USD*

* Approximate price conversion

 Address:

3 Rue de la Loge L-1945 Luxembourg

 Contact

Thomas Peltier • P: +352.27.40.99.90 • M: +352.621.326.323

 E-mail:

t.peltier@seastemia.com

DESCRIPTION

The Custom Line Navetta range with semi-displacement hull has been created for lovers of slow motion cruising in elegant onboard comfort. Owners can express their own dreams to the full, personalising both the environments and the sailing experience with a huge range of options to choose from, perfect performance in all conditions with super-efficient functionality and management systems. This 37 Meters Tri-Deck, part of the already successful timeless range of Navettas totally redesigned by Francesco Paskowski, for the beauty of our eyes, is a unique opportunity on the market to acquire a fully optioned and MCA compliant commercial Superyacht, which would be a perfect charterer. She is full on her specification Custom Line 37 meters at the edge of yachting new developments at a very attractive price, and with immediate availability.

SPECIFICATIONS

BOAT DETAILS

Main Category	Commercial vessel	Boat Status	Brokerage
Built Year	2019	Registry	Portugal
Tax Status	VAT unpaid		

CERTIFICATION

Certification	RINA	Compliance	MCA Short range
----------------------	------	-------------------	-----------------

BUILDER / DESIGNER

Builder	Ferretti Custom Line	Designer	Francesco Pawkowski
Naval Architect	Custom line Yachts	Model	37 Meters Tri Deck
Hull Type	Semi Displacement	Hull Material	GRP

DIMENSIONS

Length	37.04 M / 121'53"	Beam	8.00 M / 26'25"
---------------	-------------------	-------------	-----------------

DIMENSIONS

Draft	2.26 M / 7'41"	Displacement	209.00 tons
Ballast Weight	209.00 tons		

MACHINERY

Engine Maker	MAN	Drive	Shaft
Number of Engines	2	Propulsion Mode	Diesel
Engine(s) power	1,400.00 hp	Engine 1 hours	2,100.00 H.
Engine 2 hours	2,100.00 H.	Gearboxes/Transmission	ZF
Main Generator Maker	Kohler	Main Generator Power	70.00 KW
Main Generator Hours	700.00 H.	Auxiliary Generator Maker	Kohler
Auxiliary Generator Power	70.00 KW	Auxiliary Generator Hours	700.00 H.
Stabilizer Type	Hydraulic Thins	Stabilizer Maker	Zero speed and underways
Water Maker	Idromar	Water Maker Flow	360.00 l/H / 95.04 gal/H
AC type	Tropical with UTA system		

PERFORMANCES

Cruising Speed	13.00 knots	Max Speed	16.50 knots
Range	1,750.00 NM	Cruising Speed for Range	13.00 knots

TANKAGES

Fuel	35,000.00 liters / 9,240.00 US gals	Water	4,000.00 liters / 1,056.00 US gals
Grey Water	1,000.00 liters / 264.00 US gals	Black Water	1,000.00 liters / 264.00 US gals

ACCOMODATIONS

Sleeps	10 guests	Berths	2 simple, 4 double
Crew	6	Crew Berths	6

COMMUNICATION & NAVIGATION EQUIPMENT

Flir thermal night vision CCTV / Super Premium full integrated bridge / AIS Furuno Class B / Monitor Video for Navnet B.B. in crew mess / CCTV 15" video monitor in crew mess / 4G or Wi-Fi internet connection & internal Wi-Fi system / V-SAT predisposition / Radar Furuno Farr / Simrad RG80C Gyrocompass / ECDIS Furuno FMD3200 + charts / Additional repeater for gyrocompass / CCTV NVR system with 8 hidden cameras / CCTV DVR system with 7 cameras

RECREATIONAL EQUIPMENT

Sonance external speakers / KVH HD11 Satellite Antenna with receivers in MD and UD salon, 5 cabins / TV55" in main salon / TV55" in master cabin / TV48" in guest and VIP cabins / TV65" in upper deck salon / TV28" in captain cabin / B&O sound system in main salon / 5 + 1 sound system in master cabin / Control of entertainment, A/C, lights and curtains via iPad on all decks / Williams tender 565 Diesel Jet



37.04 M / 121'53"



37.04 M / 121'53"









37.04 M / 121'53"







37.04 M / 121'53"





37.04 M / 121'53"













LOWER DECK



MAIN DECK



UPPER DECK

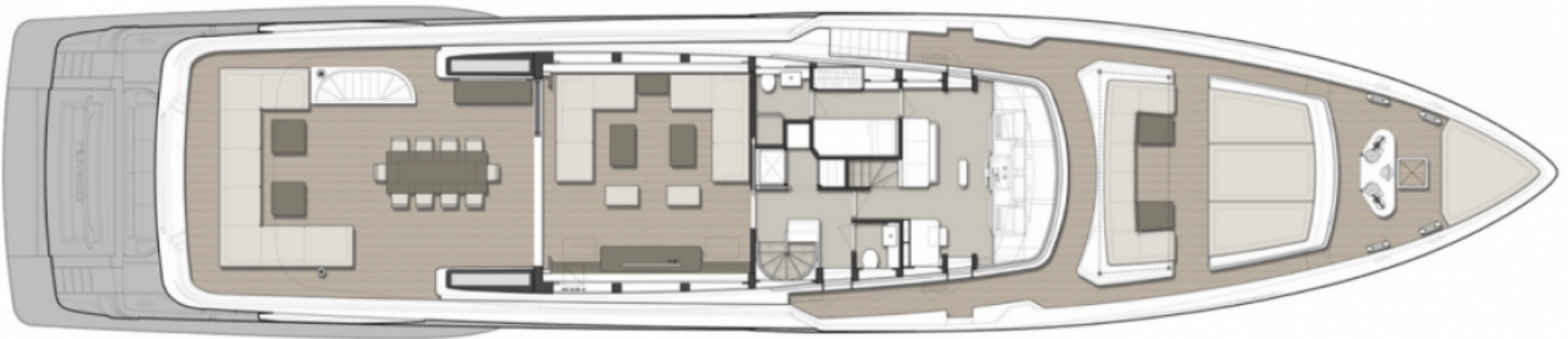

SUN DECK

